

## Modular Cooking Range Line 700XP One Well Freestanding Gas Fryer 7 liter

ITEM # \_\_\_\_\_

MODEL # \_\_\_\_\_

NAME # \_\_\_\_\_

SIS # \_\_\_\_\_

AIA # \_\_\_\_\_

**371068 (E7FRGD1BF0)**

 7-lt gas Fryer free standing  
 with 1 "V" shape well  
 (external Burners) and 1  
 basket

### Short Form Specification

#### Item No.

To be installed on height adjustable feet in stainless steel. High efficiency 7 kW burners in stainless steel. Suitable for natural gas or LPG. Deep drawn V-shaped well. Oil drains through a tap into a container under the well. Exterior panels in stainless steel with Scotch Brite finish. One piece pressed work top in 1.5 mm thick stainless steel. Right-angled side edges to allow flush-fitting junction between units.

### Main Features

- Unit to be mounted on 50mm height adjustable feet in stainless steel.
- Deep drawn V-Shaped well.
- High efficiency 7 kW burners in stainless steel with flame failure device attached to the outside of the well.
- Thermostatic regulation of oil temperature up to a maximum of 185 °C.
- Flame failure device on each burner.
- Overheat protection thermostat as standard on all units.
- Oil drains through a tap into a drainage container positioned under the well.
- All major compartments located in front of unit for ease of maintenance.
- Piezo spark ignition for added safety.
- Gas appliance supplied for use with natural or LPG gas, conversion jets supplied as standard.
- IPx4 water protection.
- Optional portable oil quality monitoring tool (code 9B8081) for efficient oil management.

### Construction

- Interior of well with rounded corners for ease of cleaning.
- All exterior panels in Stainless Steel with Scotch Brite finishing.
- One piece pressed 1.5 mm work top in Stainless steel.
- Model has right-angled side edges to allow flush fitting joints between units, eliminating gaps and possible dirt traps.

### Included Accessories

- 1 of Door for open base cupboard PNC 206350
- 1 of Basket for 7lt top and free standing fryers PNC 921608

### Optional Accessories

- Junction sealing kit PNC 206086
- Draught diverter, 120 mm diameter PNC 206126
- Matching ring for flue condenser, 120 mm diameter PNC 206127
- Flanged feet kit PNC 206136
- Frontal kicking strip for concrete installation, 400mm PNC 206147
- Frontal kicking strip for concrete installation, 800mm PNC 206148

APPROVAL: \_\_\_\_\_

- |   |   |
|---|---|
| <ul style="list-style-type: none"> <li>• Frontal kicking strip for concrete installation, 1000mm <input type="checkbox"/> PNC 206150</li> <li>• Frontal kicking strip for concrete installation, 1200mm <input type="checkbox"/> PNC 206151</li> <li>• Frontal kicking strip for concrete installation, 1600mm <input type="checkbox"/> PNC 206152</li> <li>• Frontal kicking strip, 400mm (not for refr-freezer base) <input type="checkbox"/> PNC 206175</li> <li>• Frontal kicking strip, 800mm (not for refr-freezer base) <input type="checkbox"/> PNC 206176</li> <li>• Frontal kicking strip, 1000mm (not for refr-freezer base) <input type="checkbox"/> PNC 206177</li> <li>• Frontal kicking strip, 1200mm (not for refr-freezer base) <input type="checkbox"/> PNC 206178</li> <li>• Frontal kicking strip, 1600mm (not for refr-freezer base) <input type="checkbox"/> PNC 206179</li> <li>• Kit 4 feet for concrete installation (not for 900 line free standing grill) <input type="checkbox"/> PNC 206210</li> <li>• Pair of side kicking strips <input type="checkbox"/> PNC 206249</li> <li>• Pair of side kicking strips for concrete installation <input type="checkbox"/> PNC 206265</li> <li>• Chimney upstand, 400mm <input type="checkbox"/> PNC 206303</li> <li>• Right and left side handrails <input type="checkbox"/> PNC 206307</li> <li>• Back handrail 800mm, Marine <input type="checkbox"/> PNC 206308</li> <li>• Flue condenser for 1/2 module, 120 mm diameter <input type="checkbox"/> PNC 206310</li> <li>• Door for open base cupboard <input type="checkbox"/> PNC 206350</li> <li>• Base support for feet or wheels - 400mm (700/900) <input type="checkbox"/> PNC 206366</li> <li>• Base support for feet or wheels - 800mm (700/900) <input type="checkbox"/> PNC 206367</li> <li>• Base support for feet or wheels - 1200mm (700/900) <input type="checkbox"/> PNC 206368</li> <li>• Base support for feet or wheels - 1600mm (700/900) <input type="checkbox"/> PNC 206369</li> <li>• Base support for feet or wheels - 2000mm (700/900) <input type="checkbox"/> PNC 206370</li> <li>• Rear paneling - 600mm (700/900XP) <input type="checkbox"/> PNC 206373</li> <li>• Rear paneling - 800mm (700/900) <input type="checkbox"/> PNC 206374</li> <li>• Rear paneling - 1000mm (700/900) <input type="checkbox"/> PNC 206375</li> <li>• Rear paneling - 1200mm (700/900) <input type="checkbox"/> PNC 206376</li> <li>• Chimney grid net, 400mm (700XP/900) <input type="checkbox"/> PNC 206400</li> <li>• Base support for feet/wheels (600mm) <input type="checkbox"/> PNC 206431</li> <li>• 2 side covering panels for free standing appliances <input type="checkbox"/> PNC 216000</li> <li>• Basket for 7lt top and free standing fryers <input type="checkbox"/> PNC 921608</li> </ul> | <ul style="list-style-type: none"> <li>• Filter for fryer oil collection basin for 7lt, 14lt, 15lt free standing fryers <input type="checkbox"/> PNC 921693</li> <li>• Pressure regulator for gas units <input type="checkbox"/> PNC 927225</li> <li>• 2 baskets for 2x5lt and 7lt electric fryers <input type="checkbox"/> PNC 960638</li> </ul> |
|---|---|

Front

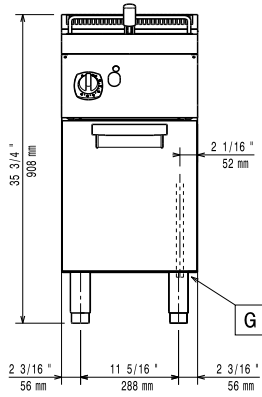

Side

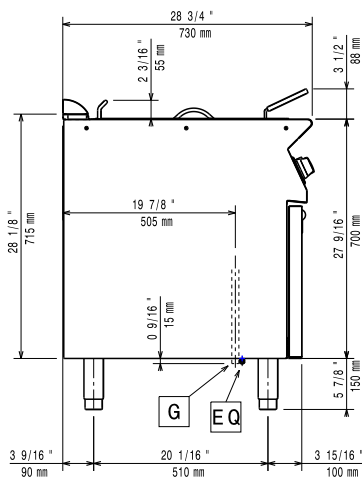

EQ = Equipotential screw  
 G = Gas connection

Top

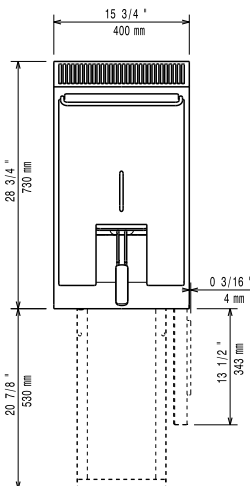

## Gas

<b>Gas Power:</b>	371068 (E7FRGD1BF0)	7 kW
<b>Standard gas delivery:</b>		Natural Gas G20 (20mbar)
<b>Gas Type Option:</b>		LPG; Natural Gas
<b>Gas Inlet:</b>		1/2"
<b>LPG Gas Pressure:</b>		11" w.c. (27.7 mbar)

## Key Information:

<b>Usable well dimensions (width):</b>	240 mm
<b>Usable well dimensions (height):</b>	235 mm
<b>Usable well dimensions (depth):</b>	380 mm
<b>Well capacity:</b>	5.5 lt MIN; 7 lt MAX
<b>Thermostat Range:</b>	105 °C MIN; 185 °C MAX
<b>Net weight:</b>	40 kg
<b>Shipping weight:</b>	49 kg
<b>Shipping height:</b>	1120 mm
<b>Shipping width:</b>	460 mm
<b>Shipping depth:</b>	820 mm
<b>Shipping volume:</b>	0.42 m <sup>3</sup>

If appliance is set up or next to or against temperature sensitive furniture or similar, a safety gap of approximately 150 mm should be maintained or some form of heat insulation fitted.

**Certification group:** N7FG