

# Big impact – small footprint



## Machine with mains water connection

with hopper extension and powder dosing unit      without hopper extension and powder dosing unit

## Machine with water tank

with hopper extension and powder dosing unit      without hopper extension and powder dosing unit

**Note: A300 and SU03 currently unavailable in North America**

### 1 A300 Options

- Second grinder
- Bean hopper without hopper extension: 1 x 0.5 kg or 2 x 0.25 kg with hopper extension: 1 x 1.1 kg or 2 x 0.55 kg lockable
- One or two separate powder dosing units: 1 x 0.5 kg or 2 x 0.5 kg (for chocolate or milk powder), lockable
- Coffee grounds chute assembly
- Steam wand (only available on MS EC models)
- Mains water connection or water tank 4.8l

### 2 Cooling Unit (SU03) and Milk Systems

- Compact, 3l milk capacity
- Expand functionality of the SU03 cooling unit with optional, integrated accounting system
- FoamMaster™ (FM): hot milk and milk foam, individually adjustable consistency
- Milk system (MS): hot milk and milk foam, exact dosing via milk pump
- Integrated cleaning system

### 2 Cleaning System

- EasyClean (EC): automatic cleaning system with manual addition of the cleaning fluid. Perfect hygiene in just a few steps.

## Flexibility

Our product portfolio allows various assembly options — tailored to your needs.



**Franke Kaffeemaschinen AG**  
cs-info.ch@franke.com

**Franke Coffee Systems GmbH**  
cs-info.de@franke.com

**Franke Coffee Systems Americas**  
cs-coffeesales.us@franke.com

**Franke Coffee Systems UK**  
sales@frankecoffeesystems.co.uk

coffee.franke.com

590.0690.062/09.22/CH-EN/Subject to dimensional, design and version changes.



# A300



Minimalist and powerful, the A300 is our most compact coffee machine. We designed it to fit anywhere – even in small restaurants, boutique hotels or the workplace. Equipped with our FoamMaster™ milk system and the automatic cleaning system EasyClean, this premium fully automatic coffee machine provides unforgettable coffee moments with a wide range of beverages.

You can rely on it: The A300 delivers high in-cup quality. Because space should never get in the way of a good cup of coffee.

CAPACITY*	SINGLE	PARALLEL
Espresso	124	163
Cappuccino	92	131
Coffee	80	92
Hot water	96	

\*Cups per hour according to DIN 18873 (Power: 220-240V)



**EasyClean**  
Automatic cleaning system — perfect hygiene in just a few steps



**Touch Screen**  
Easy to use and follow, even for new users



**FoamMaster™**  
For perfect foam, every time

# Technical Data

## Machine Models

Model	Power
A300 NM	220-240 V 1LNPE 50/60 Hz 2.1-2.3 kW (10 A) 110-127V 1LNPE 60Hz 1.2-1.5 kW (15A) 100V 1LNPE 50/60 Hz 1.4 kW (15A) 220V 1LNPE 2.1 kW (10A)
A300 MS EC	220-240 V 1LNPE 50/60 Hz 2.1-2.3 kW (10 A) 110-127V 1LNPE 60Hz 1.2-1.5 kW (15A) 100V 1LNPE 50/60 Hz 1.4 kW (15A) 220V 1LNPE 2.1 kW (10A)
A300 FM EC	220-240 V 1LNPE 50/60 Hz 2.1-2.3 kW (10 A) 110-127V 1LNPE 60Hz 1.2-1.5 kW (15A) 100V 1LNPE 50/60 Hz 1.4 kW (15A) 220V 1LNPE 2.1 kW (10A)
Dimensions with water tank	Without hopper extension, without powder dosing unit 340 mm / 465 mm / 587 mm (W / H / D)  With hopper extension, with powder dosing unit 340 mm / 545 mm / 587 mm (W / H / D)
Dimensions with mains water connection	Without hopper extension, without powder dosing unit 270 mm / 465 mm / 587 mm (W / H / D)  With hopper extension, with powder dosing unit 270 mm / 545 mm / 587 mm (W / H / D)
Weight (empty)	approx. 25kg

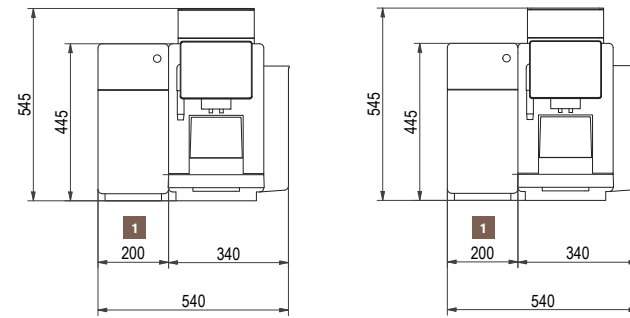

Option with internal water tank

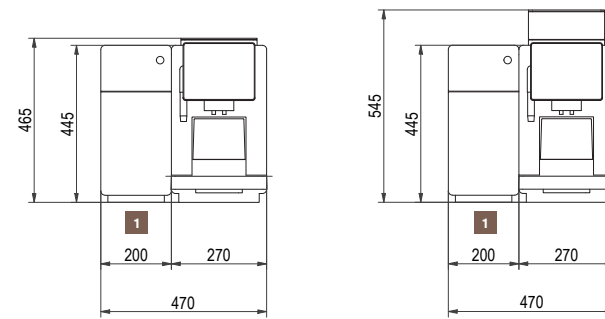

Option with mains water connection

## Mains water connection

Mains water connection	Metal hose with union nut G3/8", L = 1500 mm
Water supply line	If possible on installation side: untreated water of drinking water quality (not from household decalcification system)
Water pressure	80-800 kPa (0.8-8.0 bar)
Flowrate	>0.1l/sec
Water temperature	<25°C
Total hardness	4-8 °dH GH (German total hardness)/ 7-14 °fH GH (French total hardness)/ 70-140 ppm (mg/l)
Carbonate hardness	3-6 °dH KH (carbonate hardness)/ 50-105 ppm (mg/l)
Acid content/pH value	6.5-7.5 pH
Chlorine content	<0.5 mg/l

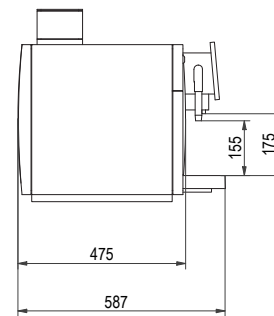

## Water drain

Drain hose	Dia. = 16 mm, L = 2000 mm
------------	---------------------------

## Add-on units

Cooling unit	SU03 EC (3L)
Electrical connection	220-240 V 1LNPE 50/60 Hz 0.5 A (10 A) 110-115 V 1LNPE 60 Hz 1.0 A (15 A) 100 V 1LNPE 50/60 Hz 1.0 A (15 A) 220 V 1LNPE 50 Hz 0.5 A (10 A)
Dimensions	200 mm / 445 mm / 466 mm (W/H/D)
Weight (empty)	approx. 14.5 kg
Compatible with	Model A300 MS EC / A300 FM EC
Color	Black

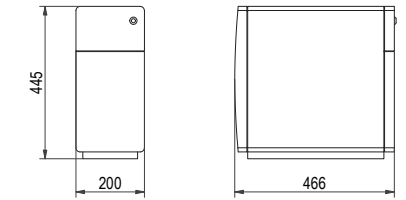

Cooling unit	SU05 EC (5L)
Electrical connection	220-240 V 1LNPE 50/60 Hz 0.72 A (10 A) 120 V 1LNPE 60 Hz 1.5 A (10 A) 220 V 1LNPE 50 Hz 0.72 A (10 A) 100 V 1LNPE 50/60 Hz 1.65 A (10 A)
Dimensions	270 mm / 445 mm / 475 mm (W/H/D)
Weight (empty)	approx. 20 kg
Compatible with	Model A300 MS EC / A300 FM EC
Color	Black

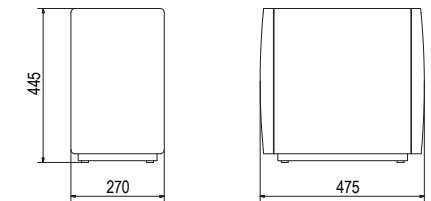

Cooling unit	KE200 (4L)
Electrical connection	220-240 V 1LNPE 0.3-0.35 A 10 A 50/60Hz 100-127 V 1LNPE 1.35 A 60 Hz
Dimensions	225 mm / 330 mm / 453 mm (W/H/D)
Weight (empty)	13 kg
Compatible with	Model A300 MS EC / A300 FM EC
Color	Black

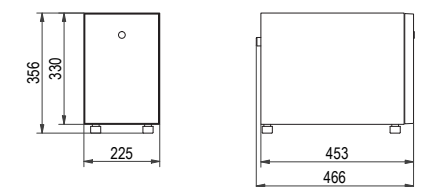

Accounting System	AC125 CL
Electrical connection	85-264V 1LNPE 50/60 Hz (10A)
Dimensions	125 mm / 150 mm / 310 mm (W/H/D)
Weight (empty)	approx. 2 kg
Color	Black

